

Manufacturing dates: 1967 - 1976

**EXPLODED VIEW, PARTS AND PRICE LIST**  
**Model M-1**

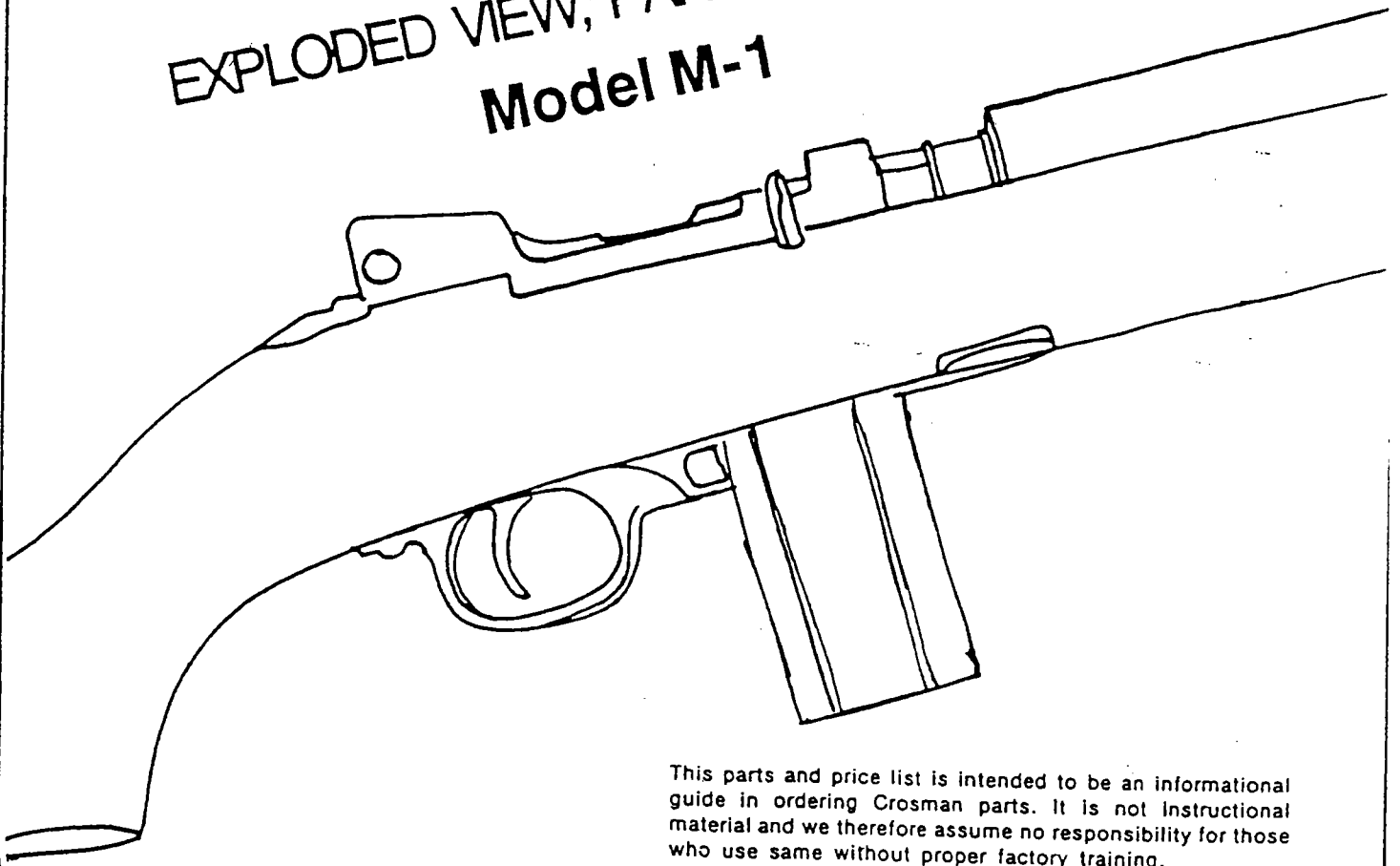

This parts and price list is intended to be an informational guide in ordering Crosman parts. It is not instructional material and we therefore assume no responsibility for those who use same without proper factory training.

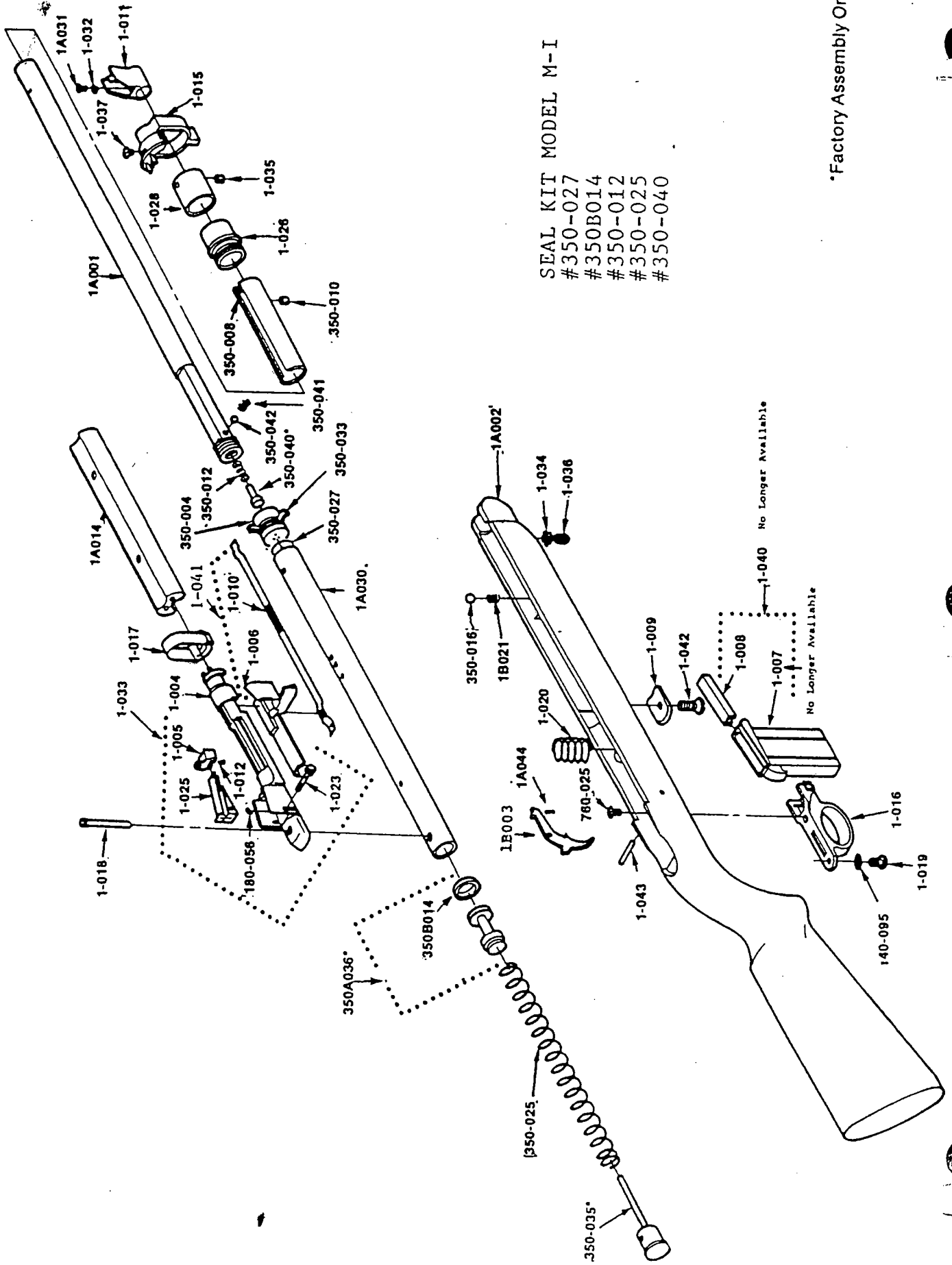

SEAL KIT MODEL M-I  
 #350-027  
 #350B014  
 #350-012  
 #350-025  
 #350-040

\*Factory Assembly Only

TO BE USED AS REFERENCE GUIDE ONLY

## Model M-1 Assemblies and Parts List

<u>PART #</u>	<u>QTY</u>	<u>DESCRIPTION</u>	<u>PRICE</u>	<u>PART #</u>	<u>QTY</u>	<u>DESCRIPTION</u>	<u>PRICE</u>
1A001	1	Barrel		1-033	1	Rear Sight Assembly	
1A002	1	Stock No Longer Available		1-034	1	Lock Washer	
1B003	1	Trigger		1-035	1	Tube Stud	
1-004	1	Rear Sight Mount		1-036	1	Tube Support Screw	
1-005	1	Rear Sight		1-037	1	Stock Clamp Screw	
1-006	1	Action Lever		1-040	1	Magazine Assembly. No Longer	
1-007	1	Magazine No Longer Available		1-041	1	Action Lever Assembly	
1-008	1	Magazine Cover		1-042	1	Stock Screw	
1-009	1	Magazine Support		1-043	1	Trigger Pin	
1-010	1	Hole Cover		1A044	1	Trigger Spring	
1-011	1	Front Sight		140-095	1	Screw Lock Washer	
1-012	1	Sight Spring		180-056	1	Retainer	
1A014	1	Hand Grip		350-004	1	Barrel Cap	
1-015	1	Stock Clamp		350-008	1	Spacer	
1-016	1	Trigger Guard		350-010	1	Guide Screw	
1-017	1	Collar		350-012	1	Valve Spring	
1-018	1	Locating Stud		350B014	1	Piston Ring	
1-019	1	Stock Screw		350-016	1	Barrel Lock Ball	
1-020	1	Magazine Spring		350-025	1	Piston Spring	
1B021	1	Barrel Lock Spring		350-027	1	O Ring	
1-023	1	Sight Adjusting Screw		350-033	1	Felt	
1-025	1	Sight Elevator		350-035*	1	Tube Plug & Stop Assy.	
1-026	1	Tube Bearing		350A036*	1	Hammer & Piston Assy.	
1-028	1	Support Ring		350-040*	1	Pop Valve Assembly	
1A030	1	Tube		350-041	1	Retainer Ball Srping	
1A031	1	Front Sight Screw		350-042	1	Retainer Ball	
1-032	1	Front Sight Washer		760-025	1	Receiver Screw	

Order by part number and description. Prices subject to change without notice. Check or money order in the amount of total purchase must accompany parts order.