

MARK I Manufactured from 1966 to 1984
MARK II Manufactured from 1966 to 1986

EXPLODED VIEW, PARTS AND PRICE LIST Models MK-I and II

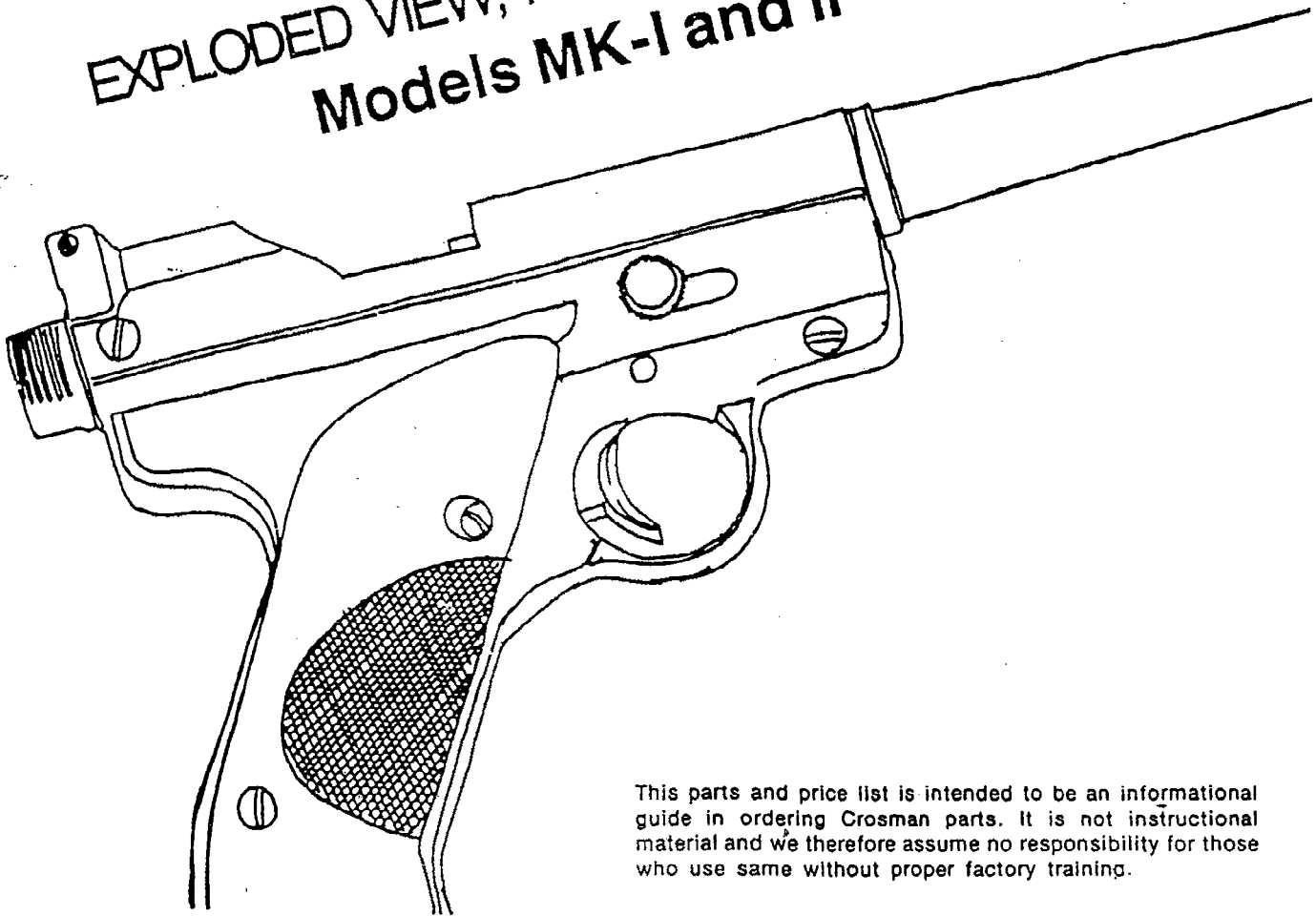

This parts and price list is intended to be an informational guide in ordering Crosman parts. It is not instructional material and we therefore assume no responsibility for those who use same without proper factory training.

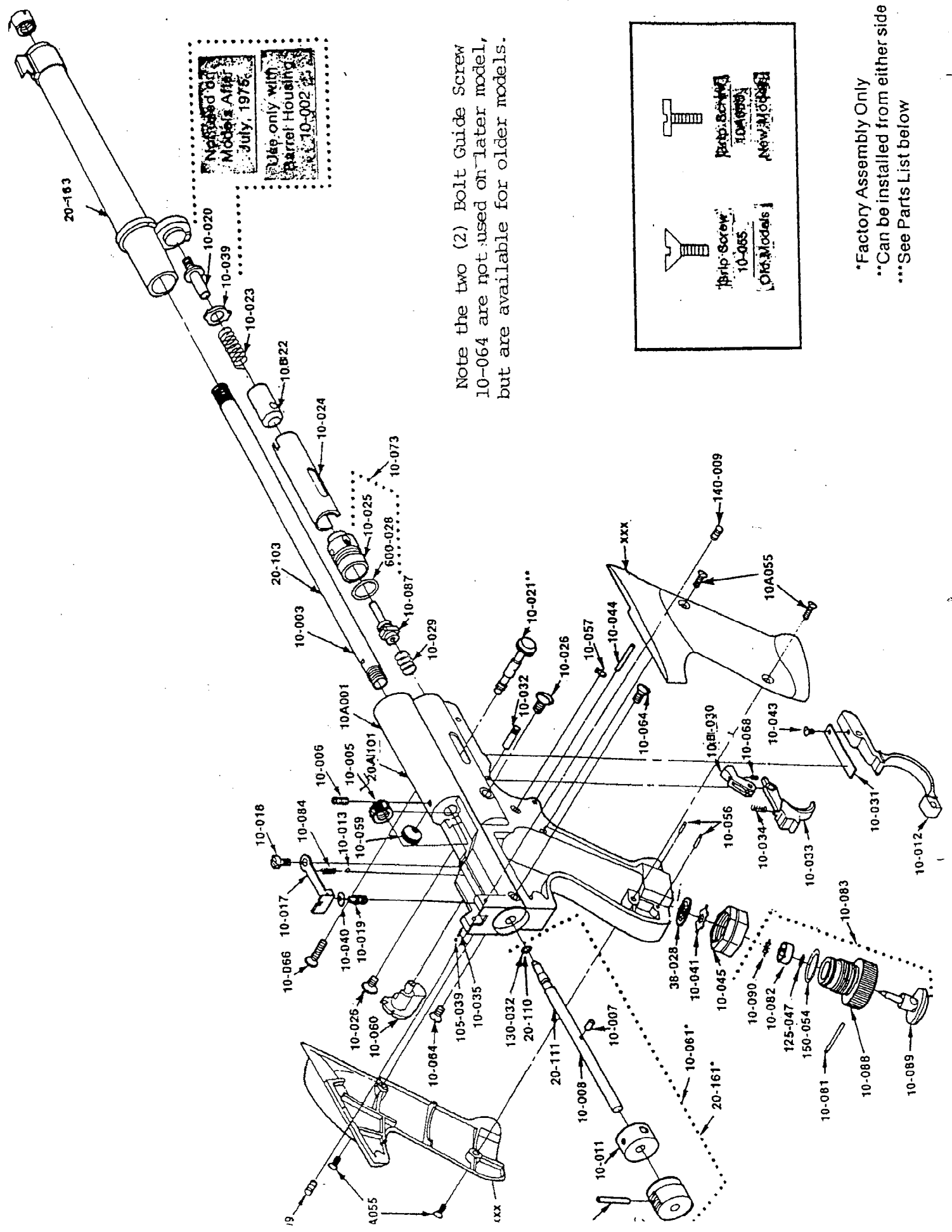

Not used on Models After July, 1975.
Use only with Parrel Housing 10-002

Note the two (2) Bolt Guide Screw 10-064 are not used on later model, but are available for older models.

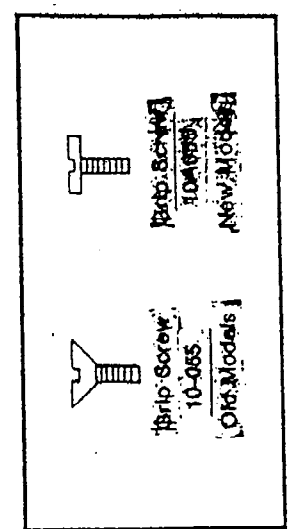

*Factory Assembly Only
**Can be installed from either side
***See Parts List below

Models MK-I and MK-II Assemblies and Parts List

PART #	DESCRIPTION	PRICE	PART #	QTY	DESCRIPTION	PRICE
10A001	Frame - Stripped MK1		10-055	4	Grip Screw-long	
10-003	Barrel MK1		10-056	2	Piercing Nut Pin	
10-004	Barrel Nut - front		10-057	1	Safety Retainer Ring	
10-005	Barrel Nut - rear		10-059	1	Cocking Knob End	
10-006	Set Screw - barrel		10-060	1	Safety Assembly	
10-007	Bolt Pin		10-061*	1	Bolt Assembly MK1	
10-008	Breach Bolt MK1		10-064	2	Bolt Guide Screw	
10-010	Knob Pin		10-066	1	Trigger Guard Screw	
10-011	Bolt Guide		10-068	1	Sear Screw	
10-012	Trigger Guard		10-073	1	Valve Body Assembly	
10-013	Detent Ball		10-078***	1	Grip Set RH Brown MK1	
10-017	Sight Blade		10-079***	1	Grip Set LH Brown MK1	
10-018	Sight Screw		10-081	1	Retainer Pin	
10-019	Elevation Screw		10-082	1	Piercing Plug	
10-020	Spring Adjustment Screw		10-083	1	Piercing Assembly	
10-021	Cocking Knob		10-084	1	Bolt Detent Spring	
10B022	Hammer		10-087	1	Valve Stem Assembly	
10-023	Hammer Spring		10-088	1	Piercing Knob	
10-024	Hammer Sleeve		10-089	1	Piercing Pin	
10-025	Valve Body		10-090	1	Plug Retainer	
10-026	Valve Screw		10-093	1	Bolt Knob	
10-029	Valve Spring		20-078***	1	Grip Set RH MK11 Black	
10B030	Sear		20-079***	1	Grip Set LH MK11 Black	
10-031	Sear Spring		20A101	1	Frame - Stripped MK11	
10-032	Trigger Pivot Pin		20-103	1	Barrel MK11	
10-033	Trigger		20-110	1	Bolt Seal - MK11	
10-034	Trigger Spring		20-111	1	Bolt & Magnet Assy. MK11	
10-035	Safety Detent Spring		20-161*	1	Bolt Assembly MK11	
10-039	Hammer Spring Washer		20-163	1	Barrel Housing-stripped	
10-040	Elevation Screw Washer		38-028	1	Piercing Screen	
10-041	Screen Retainer		105-039	1	Detent Ball (Safety)	
10-043	Sear Spring Screw		125-047	1	Piercing Pin Seal	
10-044	Trigger Guard Pin		130-032	1	Bolt Seal - MK1	
10-045	Piercing Body Nut		140-009	2	Windage Screw	
10A055	Grip Screw		150-054	1	Piercing Body O-ring	
			600-028	1	Valve Body Seal	

without notice. Check or money order in amount of total purchase must accompany parts order.
 Order by part number and description. Prices subject to change
 TO BE USED AS REFERENCE GUIDE ONLY