



EXPLODED VIEW PARTS AND PRICE LIST

MODEL 397 392 PHASE II

CROSMAN CORPORATION
RT 5 & 20
EAST BLOOMFIELD, NY 14443

Phone: 1-800-724-7486
Parts Order Fax: 585-657-5405

B397EVP2 B392EVP2

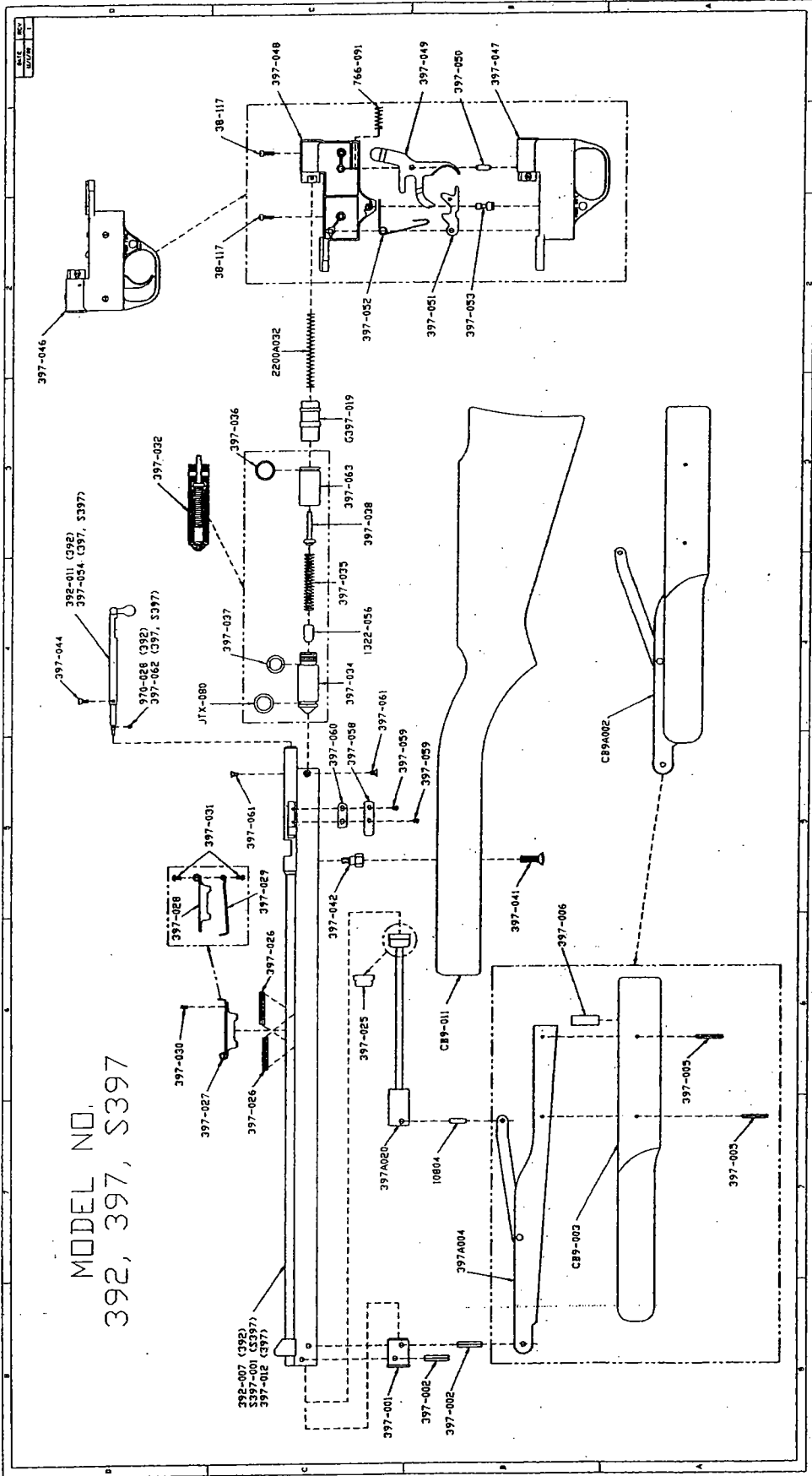

MODEL NO.
392, 397, S397

DATE	REV.
12/20/76	1

MODEL
397 S397 392
PARTS AND PRICE LIST
CARTRIDGE VALVE PHASE II (TRIGGER PACK)
START MANUFACTURE JUNE 1997

<u>PART NUMBER</u>	<u>QTY PER</u>	<u>PART NAME</u>	<u>COST</u>	
10804	1	CROSS HEAD PIN	\$1.00	
1322-056	1	CHECK VALVE	\$1.00	
2200A032	1	STRIKER SPRING	\$1.00	
38-117	2	SCREW	\$1.00	each
392-007	1	BARREL ASS'Y (392)	*	
392-011	1	BOLT ASS'Y (392)	\$6.55	
397-001	1	MUZZLE CAP	\$4.87	
397-002	2	MUZZLE CAP PIN	\$1.00	each
397-003	1	FOREARM ASS'Y	\$34.05	
397-004	1	BLACK LEVER LINK	\$10.64	
397-005	2	FOREARM PIN	\$1.00	each
397-006	1	FOREARM STOP	\$1.00	
397-007	1	FOREARM	*	
397-013	1	BARREL ASS'Y (397)	*	
397-020	1	PISTON ASS'Y	\$9.18	
397-025	1	PISTON	\$1.22	
397-026	2	GRIP BASE	\$1.00	each
397-027	1	REAR SIGHT ASS'Y	\$5.64	
397-028	1	SIGHT BASE	\$1.56	
397-029	1	SIGHT ARM	\$2.84	
397-030	1	ELEVATION SCREW	\$1.00	
397-031	2	WINDAGE SCREW	\$1.00	each
397-032	1	VALVE ASS'Y	\$18.03	
397-034	1	INLET VALVE BODY	\$5.80	
397-035	1	VALVE SPRING	\$1.00	
397-036	1	O-RING	\$1.00	
397-037	1	O-RING	\$1.00	
397-038	1	EXHUAST VALVE ASS'Y	\$2.68	
397-040	1	O-RING(was P906 use JTX-080)	*	
397-041	1	RECEIVER SCREW	\$1.00	
397-042	1	STOCK LUG	\$0.78	
397-044	1	BOLT LOCKING LUG	\$1.00	
397-046	1	TRIGGER ASS'Y	\$16.95	
397-047	1	LEFT TRIGGER CASE	\$5.80	
397-048	1	RIGHT TRIGGER CASE	\$3.20	
397-049	1	TRIGGER	\$4.25	
397-050	1	PIN	\$1.00	
397-051	1	SEAR	\$0.61	
397-052	1	SEAR SPRING	\$1.00	
397-053	1	SAFETY	\$1.26	
397-054	1	BOLT ASS'Y (397, S397)	\$5.99	
397-057	1	STOCK	\$47.96	
397-058	1	CAM FACE COVER	\$0.72	
397-059	2	CAM FACE SCREW	\$1.00	each
397-060	1	CAM FACE	\$1.00	
397-064	1	GUIDE PIN (not shown)	\$1.00	start August 2001

PRICES ARE IN U.S. DOLLARS

MODEL
397 S397 392
PARTS AND PRICE LIST
CATRTRIDGE VALVE PHASE II (TRIGGER PACK)
START MANUFACTURE JUNE 1997

<u>PART NUMBER</u>	<u>QTY PER</u>	<u>PART NAME</u>	<u>COST</u>	
397-061	2	SCREW	\$1.00	each
397-062	1	O-RING (397, S397)	\$1.00	
397-063	1	EXHAUST VALVE BODY	\$7.29	
397A003	1	FOREARM ASS'Y	\$35.05	starting ser# 899700787
397A004	1	BLACK LEVER LINK	\$11.64	starting ser# 899700787
397A020	1	PISTON ASS'Y	\$9.18	starting ser# 899700787
766-091	1	SEAR SPRING	\$1.00	
970-028	1	O-RING (392)	\$1.00	
CB9-003	1	FOREARM	\$18.59	starting January 2000
CB9A003	1	FOREARM	\$18.60	starting Sept 2001
CB9-011	1	STOCK	\$58.76	starting January 2000
CB9A002	1	FOREARM ASS'Y	\$33.26	starting January 2000
G397-019	1	STRIKER	\$1.35	
JTX-080	1	O RING	\$1.00	
S397-001	1	BARREL ASS'Y (S397)	\$104.65	

THIS PARTS AND PRICE LIST IS INTENDED TO BE AN INFORMATIONAL GUIDE IN ORDERING CROSMAN PARTS. IT IS NOT INSTRUCTIONAL MATERIAL AN WE THEREFORE ASSUME NO RESPONSIBILITY FOR THOSE WHO USE SAME WITHOUT PROPER FACTORY TRAINING.

PRICES AND PARTS ARE SUBJECT TO CHANGE WITHOUT NOTICE.

PLEASE ORDER BY PART NUMBER AND DESCRIPTION

CHECK OR MONEY ORDER FOR THE TOTAL PRICE MUST ACCOMPANY THE ORDER

*** NOT AVAILABLE**

UPDATED 9/01

PRICES ARE IN U.S. DOLLARS