

EXPLODED VIEW, PARTS AND PRICE LIST Model 766 PHASE I Manufacturing Date 1975 to 1978

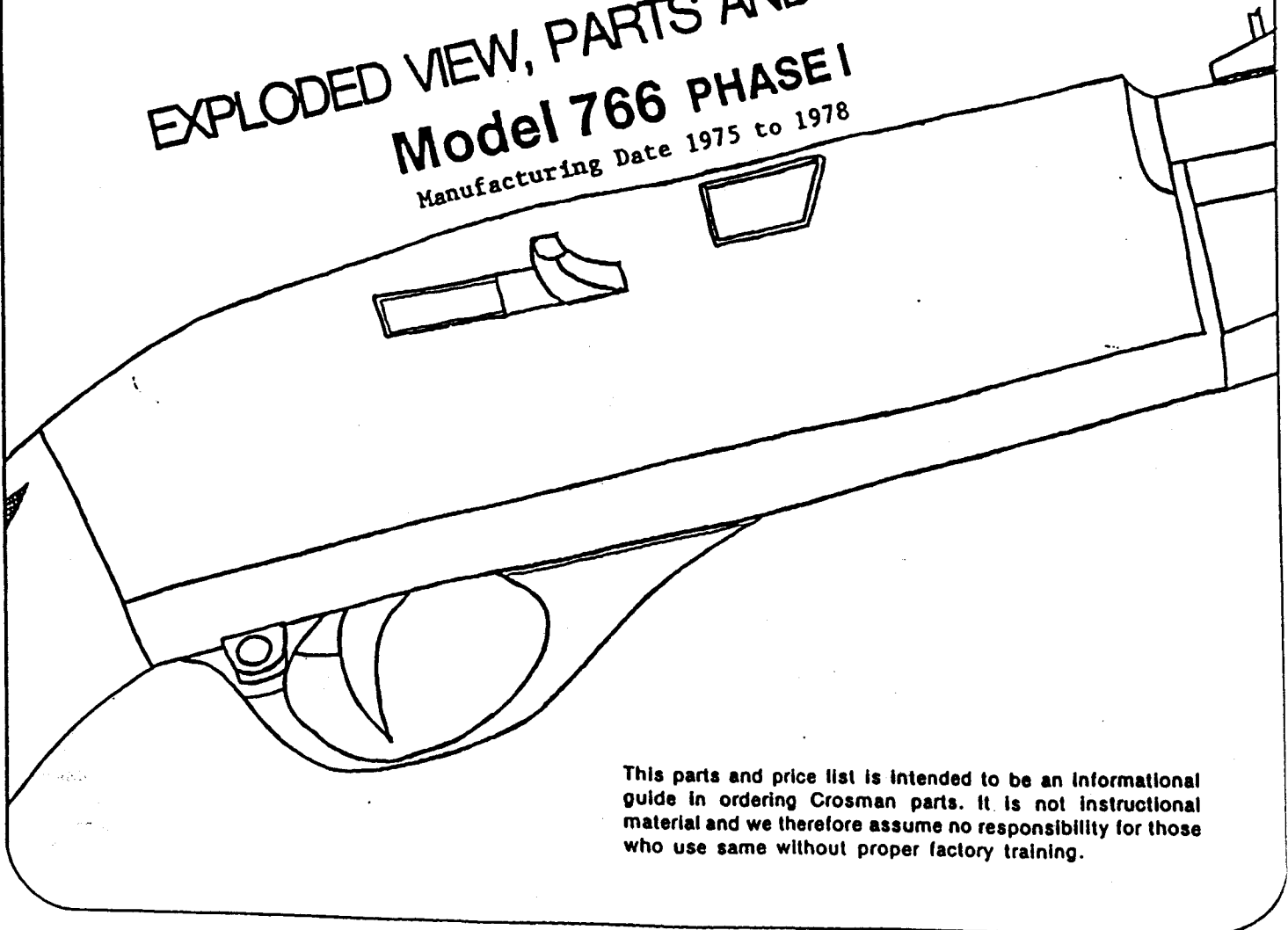

This parts and price list is intended to be an informational guide in ordering Crosman parts. It is not instructional material and we therefore assume no responsibility for those who use same without proper factory training.

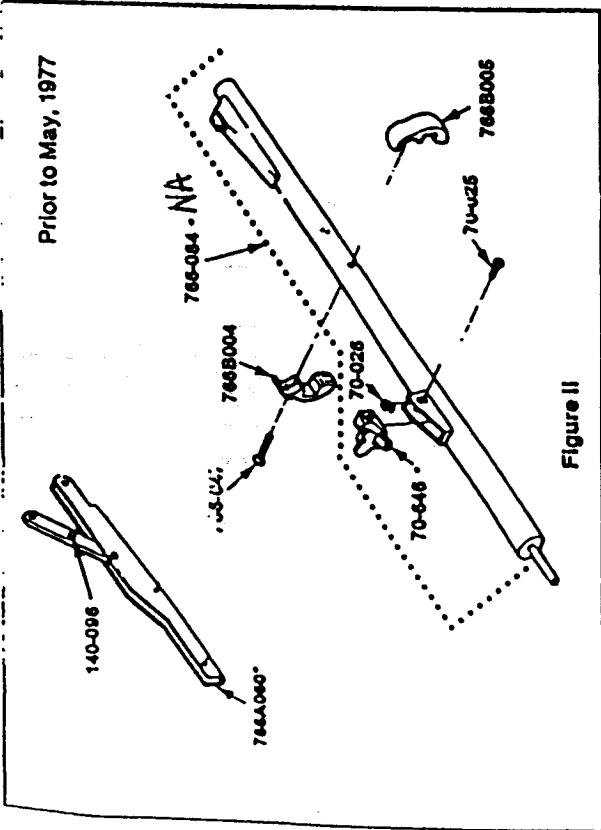

Figure II

Telescope 76-023, Trigger Pin 766-023, Trigger Spring 766-024, and Safety 2100-016 should be assembled in the order shown in this manual before replacing it with an E.M. Revolver 766002

NOTE
Check parts list for availability of parts

Seal Kit	
130-034	-
120-035	-
760-140	-
766A031	-
766A032	-
1400A029	-
7100-003	-

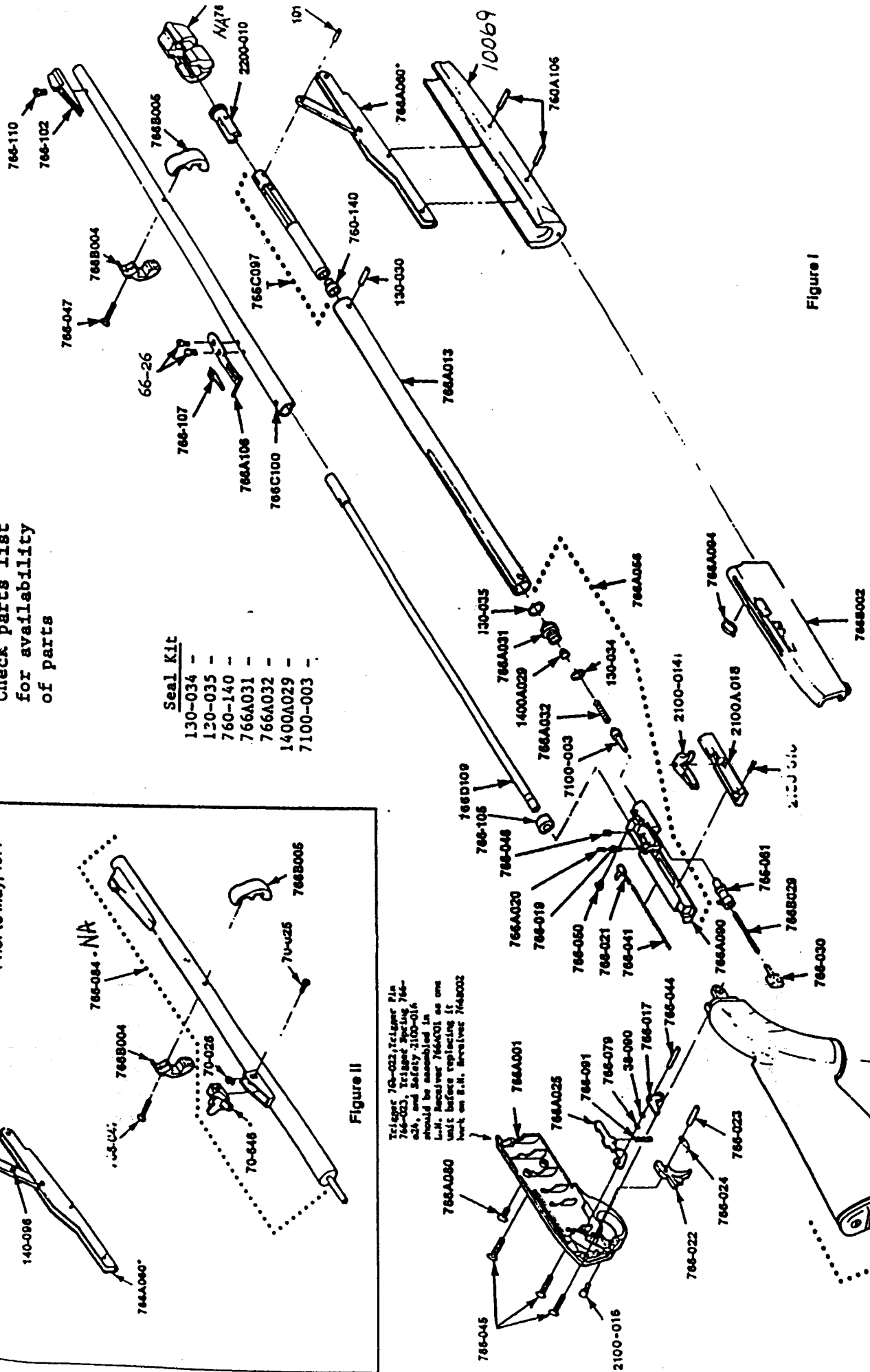

Figure I

*Factory Assembly Only