

---

## EXPLODED VIEW, PARTS AND PRICE LIST

### Model SSP 250™

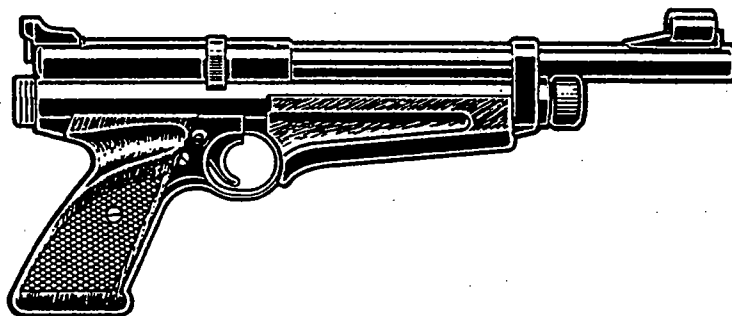

MANUFACTURE START DATE 1989

This parts and price list is intended to be an informational guide in ordering Crosman parts. It is not instructional material and we therefore assume no responsibility for those who use same without proper factory training.

Just 1990 serial # starting with 89000000 three parts were changed. The breech 151C012 is redesigned with straight sides & larger hole for breach screw 282-155 & tube 151A011 has larger hole to accept breach screw.

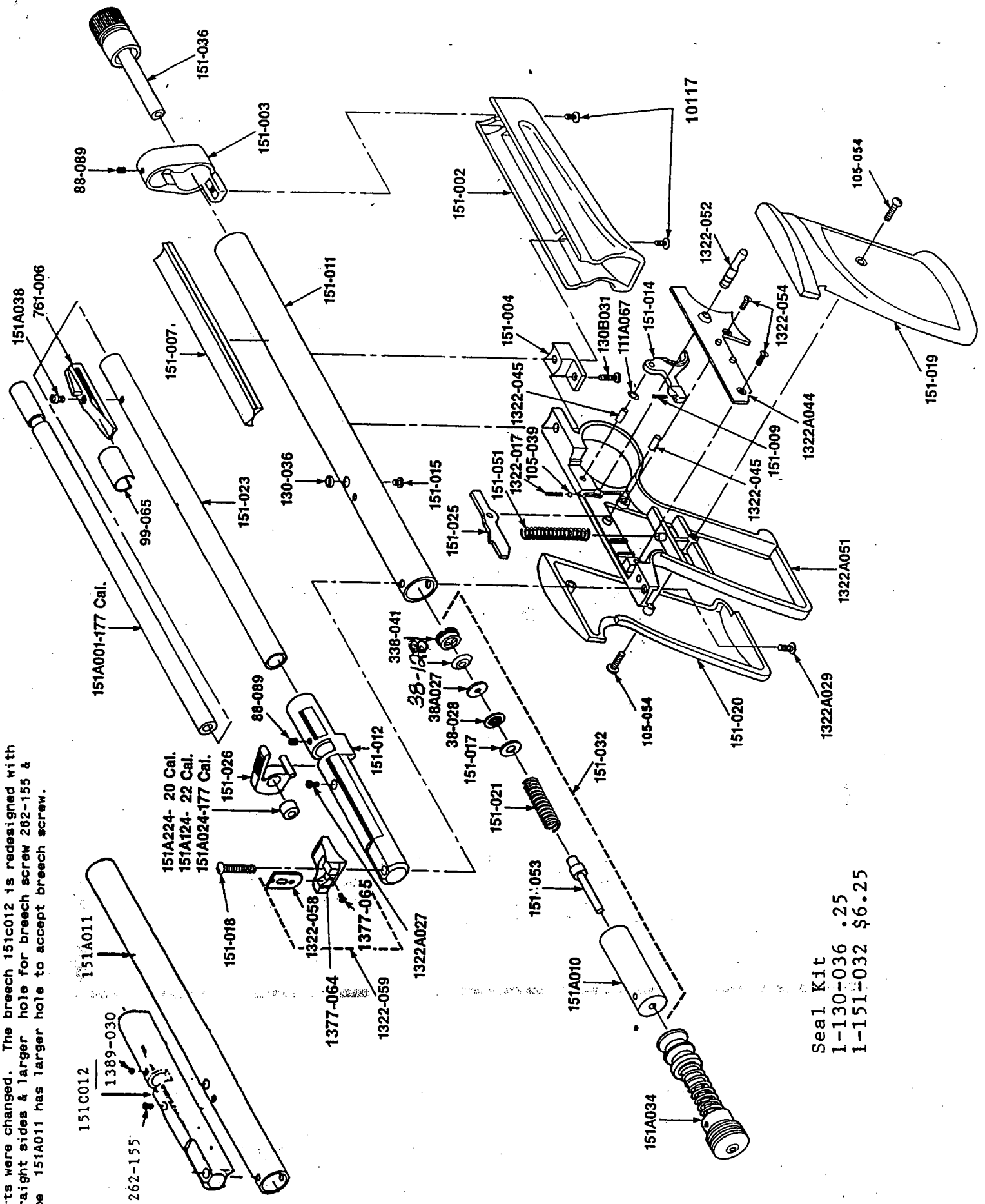

Seal Kit  
 1-130-036 .25  
 1-151-032 \$6.25

**PARTS & PRICE LIST: MODEL SSP250**

PART NO.	QTY	PART NAME	PRICE	PART NO.	QTY	PART NAME	PRICE
151A001	1	.177 CAL BARREL	\$4.89	151A224	1	.20 CAL LOADER SEAL	\$0.59
151-002	1	FOREARM	\$5.22	38A027	1	PIERCING PIN	\$0.64
151-003	1	BARREL BAND	\$2.33	38-028	1	SCREEN	\$0.50
151-004	1	FOREARM BRACKET	\$1.24	<del>38-128</del>	1	END SEAL	\$0.50
151-007	1	SPACER	\$0.61	88-089	2	SET SCREW	\$0.50
151-009	1	TRIGGER SPRING	\$0.50	99-085	1	FRONT SIGHT HOOD	\$1.80
151A010	1	VALVE BODY	\$2.98	105-039	1	SAFETY BALL	\$0.50
151A011	1	TUBE	\$6.59	105-054	2	GRIP SCREW	\$0.50
151C012	1	BREECH	\$8.16	111A067	1	SPRING WASHER	\$0.50
151-014	1	TRIGGER	\$0.50	130B031	1	FRONT FRAME SCREW	\$0.50
151-015	1	VALVE SCREW	\$0.50	130-036	1	BREECH GASKET	\$0.50
10117	2	FOREARM SCREW	\$0.50	262-155	1	BREECH SCREW	* \$0.88
151-017	1	VALVE WASHER	\$0.50	338-041	1	GUIDE COLLAR	\$0.50
151-018	1	REAR SIGHT SCREW	\$0.50	760A027	1	SET SCREW	\$0.50
151-019	1	GRIP, R.H.	\$0.96	761-006	1	FRONT SIGHT	\$0.50
151-020	1	GRIP, L.H.	\$0.96	1322-017	1	SAFETY SPRING	\$0.50
151-021	1	VALVE SPRING	\$0.50	1322A027	1	BREECH SCREW	\$0.50
151-023	1	BARREL SLEEVE	\$4.37	1322A029	1	REAR FRAME SCREW	\$0.50
151A024	1	.177 CAL. LOADER SEAL	\$0.68	1322A044	1	COVER	\$2.43
151-025	1	SEAR	\$0.50	1322-045	2	TRIGGER PIN	\$0.50
151-026	1	LOADER	\$0.99	1322A051	1	FRAME	\$4.31
* 151-032	1	VALVE ASSEMBLY	\$7.34	1322-052	1	SAFETY	\$0.50
* 151A034	1	HAMMER ASSEMBLY	\$7.03	1322-054	2	COVER SCREW	\$0.50
* 151-036	1	PIERCING KNOB ASSEMBLY	\$3.65	1322-058	1	REAR SIGHT BLADE	\$0.50
151A038	1	FRONT SIGHT SCREW	\$0.50	1322-059	1	REAR SIGHT ASSEMBLY	\$1.45
151-051	1	SEAR SPRING	\$0.50	1377-064	1	REAR SIGHT	\$0.55
* 151-053	1	VALVE STEM ASSEMBLY	\$1.43	1377-065	1	REAR SIGHT BLADE SCREW	\$0.50
151A124	1	.22 CAL LOADER SEAL	\$0.68				

\* FACTORY ASSEMBLY ONLY      PRICES SUBJECT TO CHANGE WITHOUT NOTICE  
 PLEASE ORDER BY PART NUMBER AND PART DESCRIPTION. CHECK OR MONEY ORDER  
 FOR THE TOTAL PURCHASE MUST ACCOMPANY THE PARTS ORDER.