

EXPLODED VIEW, PARTS AND PRICE LIST
Model 766 PHASE II
Manufacturing Date 1978 to 1981

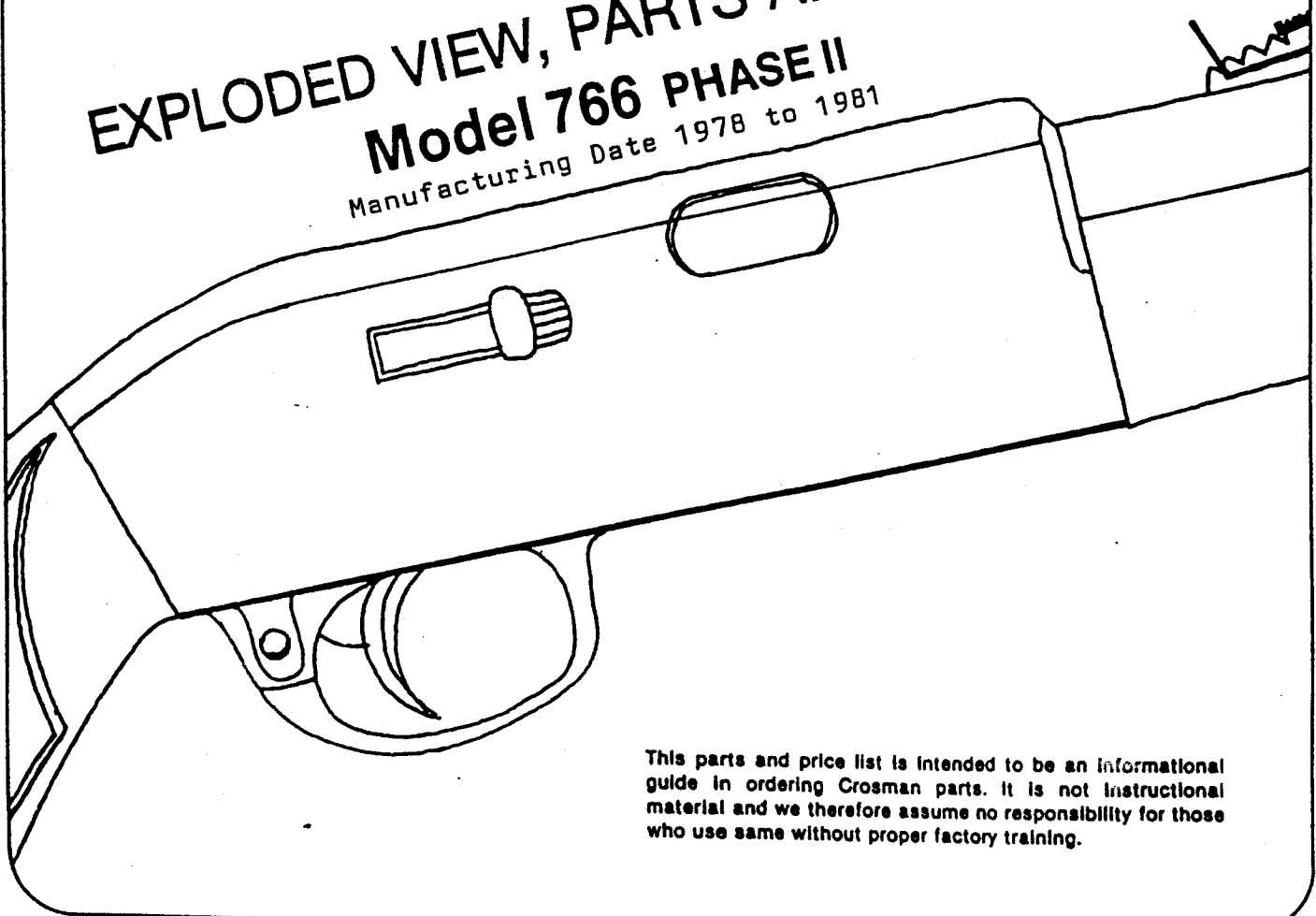

This parts and price list is intended to be an informational guide in ordering Crosman parts. It is not instructional material and we therefore assume no responsibility for those who use same without proper factory training.

REPRINT 7/93

CROSMAN AIRGUNS
Rt. 5&20 East Bloomfield, N.Y. 14443

Phase II

Trigger 766-022, Trigger Pin 766-023, Trigger Spring 766-024, and Safety 2100-016 should be assembled in L.H. Receiver 766A001 as one unit before replacing it back on R.H. Receiver 766B002

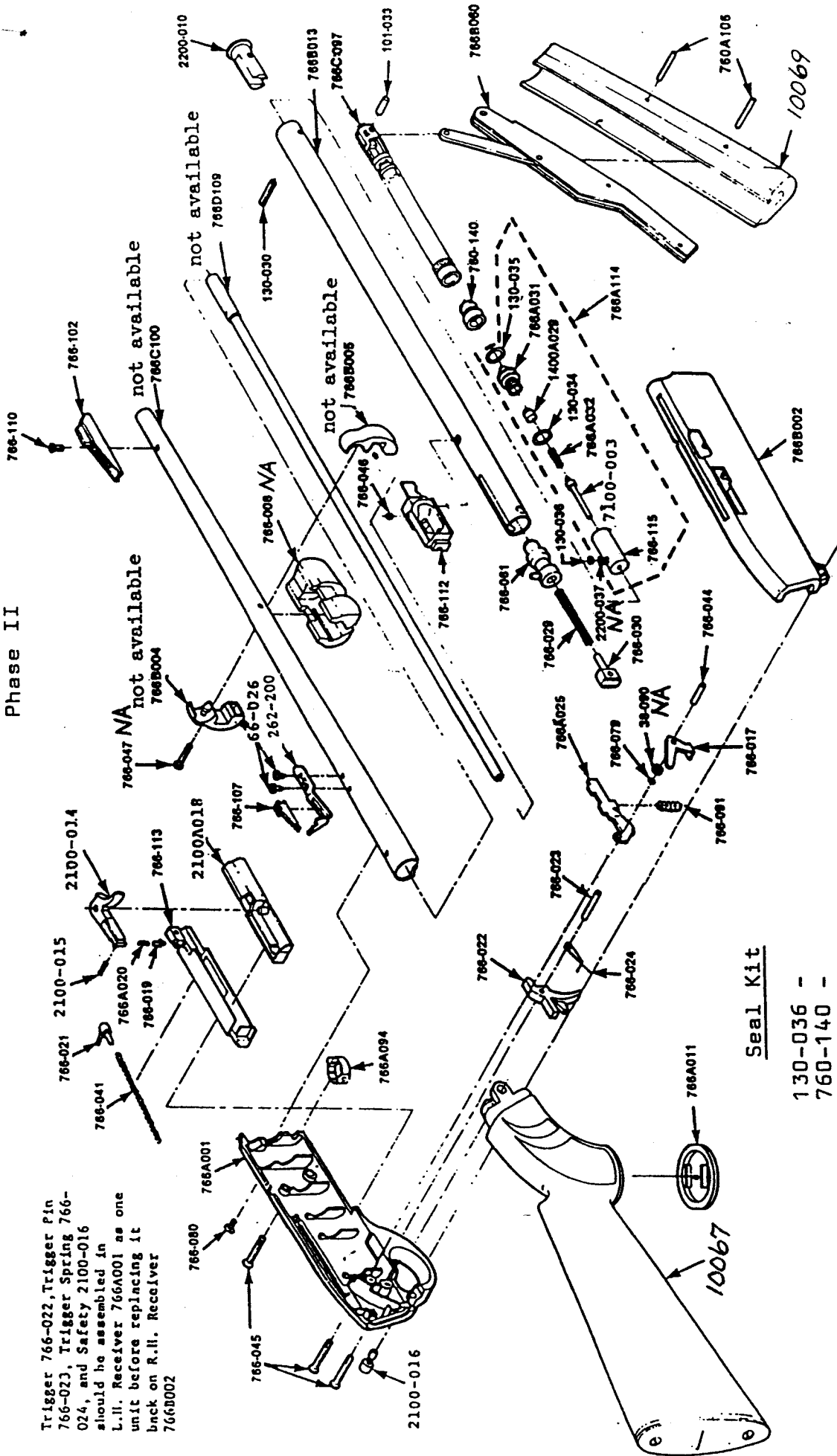

Seal Kit

- 130-036 -
- 760-140 -
- 766A114 -

*Factory Assembly Only