

 **Crosman**

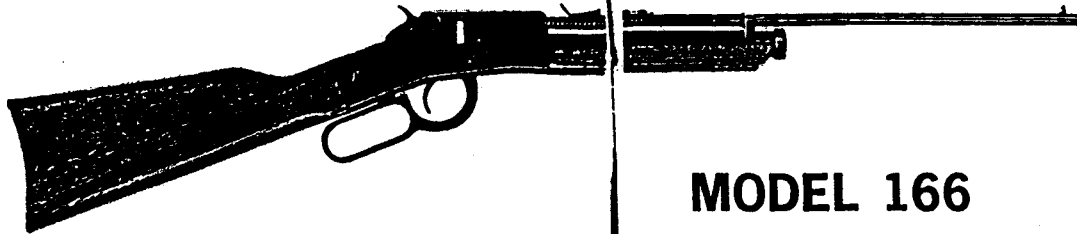

166

Owner's Manual



MODEL 166

Super BB Repeater

Gas Powered Rifle

Operating Instructions

Treat your rifle at all times as if it were loaded. Check magazine and open cocking lever, exposing Load Detector Aperture in Magnetic Swing Arm. If gun is loaded BB can be seen thru this opening. Remove any BB's before charging with gas. (See instructions "To Unload Magazine and Remove Lodged BB From Barrel.")

Read all instructions carefully before operating your gun.

Always Follow These Simple Safety Rules:

1. Treat every gun as if it is a loaded gun.
2. Always keep muzzle of gun pointed in a safe direction.
3. Don't point at anything you don't intend to shoot.
4. Check safety before loading.
5. Be sure of your target and your backstop.
6. Conduct yourself as a true sportsman in using your gun.

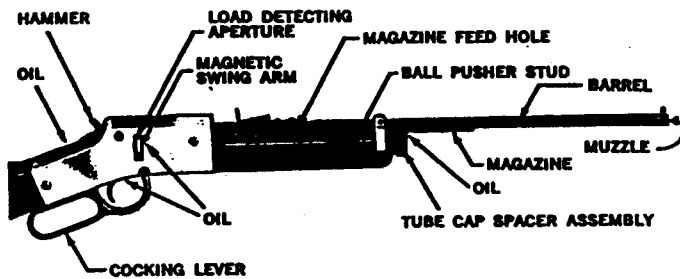

OILING POINTS

NOTICE

The valve in this gun is designed for use with the Crosman Golden Powerlet. Other type CO₂ cylinders may cause a malfunction in this gun.

TO CHARGE RIFLE WITH CO₂:

With rifle pointed in a safe direction, cock rifle to full cocked position by pulling hammer to rear as far as it will go. Fire rifle and push hammer firmly forward to exhaust remaining gas from tube. Unscrew and remove knurled Tube Cap Spacer Assembly. (If unable to turn by hand DO NOT attempt to remove with pliers or other tools as this denotes the gun is still under pressure.) Hold muzzle end down and used Powerlet will drop out. Put rifle on safe by cocking hammer to rear one notch. (Approx. 1/4" back.) Insert Powerlet (CO₂ Cylinder) into tube, neck end pointed toward stock. Screw tube cap spacer assembly firmly into place by hand. After it is turned as far as it will go, turn 1/8 turn in reverse direction.

Cock rifle to full cocked position by pulling hammer to rear as far as it will go. Squeeze trigger to pierce Powerlet and release gas into Tube, if it had not already been pierced previously. Recock rifle immediately to allow sufficient time for gas pressure to build up in tube and to seat Exhaust Valve. After approximately 30 seconds squeeze trigger to uncock. Rifle is now under compression.

NOTE: It may be necessary to repeat this operation a few times to pierce Powerlet.

IMPORTANT: Proper oiling of guns will eliminate most sealing failures. USE SPARINGLY. Excessive oiling is harmful to gun action. Three or four drops is sufficient for each seal or oiling point. Apply every 250 shots or when parts appear dry. Be sure "O" Ring on knurled tube cap is clean and free of foreign matter. Never use penetrating or detergent type oils, as they may be harmful to valve washers and seals. USE SPECIAL CROSMAN PELL-GUNOIL® FOR BEST RESULTS.

CAUTION: DO NOT expose Powerlets or your rifle to excessive heat.

NOTE: Fanning or pressing hammer forward will exhaust CO₂ gas from tube.

TO LOAD MAGAZINE WITH BB'S:

Use only CROSMAN SUPER BB's. DO NOT use lead BB's, they will not work in the Magnetic Swing Arm. DO NOT reuse damaged BB's, they will jam the Feed Arm and Barrel. INFERIOR OR OVERSIZE BB's WILL JAM AND VOID WARRANTY.

Put rifle on safe by cocking hammer to first position, one notch. (Approx. 1/4" back.) Slide Ball Pusher Stud forward (toward muzzle) and lock to left in notch. Pour BB's into magazine tube thru loading hole provided on top. Place thumb at rear of loading hole and pour BB's along barrel and magazine tube. Holding rifle at proper angle will allow BB's to drop into loading hole. Release ball pusher stud to right so that ball pusher and spring is pressing against loaded BB's.

TO SHOOT RIFLE:

Cock rifle by moving cocking lever to full open position (downward). This action automatically places BB in magnetic loading arm. BB can be visually seen through the load detecting aperture (opening) in top of swing arm. Close the cocking lever. Swing arm will put the BB in firing position. Magnet will hold BB in Swing Arm until rifle is fired. Take aim, squeeze trigger and shoot. Rifle should always be pointed in a safe direction. Rifle is ready for firing each time cocking lever is opened and closed.

TO ADJUST SIGHT:

Windage: Loosen both rear sight screws counter-clockwise. This will free rear sight allowing it to be moved right or left until proper sight adjustment has been reached. Retighten rear sight screws.

Elevation: Move rear sight elevator toward breech; to raise sight; to lower, raise rear sight slightly and at the same time push sight elevator toward muzzle.

TO UNLOAD MAGAZINE TUBE AND REMOVE LODGED BB FROM BARREL:

With rifle pointed in a safe direction, exhaust all gas from rifle by firing and pushing hammer firmly forward. Slide magazine ball pusher stud forward and lock to left in notch.

Hold rifle muzzle straight down, open cocking lever and release BB located in magnetic swing arm, thru load detecting aperture (opening), with a sharp pointed instrument. Shake all BB's out of magazine tube thru Feed Hole on top. With rifle still held muzzle end down, close cocking lever and insert a $\frac{1}{32}$ " ramrod in barrel and push defective BB back into magnetic Feed Arm. DO NOT drive or use excessive force to remove BB from barrel. Undue force will DAMAGE swing feed mechanism. Remove ramrod from barrel. Open cocking lever and release the defective BB into magazine tube, thru load detecting aperture with a sharp pointed instrument as above. Close cocking lever, turn gun over and shake defective BB out of magazine thru feed hole.

NOTE: DO NOT attempt to disassemble this rifle, it contains springs under tension. Disassembling will render the warranty invalid.

REPAIR SERVICE:

Your Super BB gun may be serviced at one of the Crosman Authorized Service Stations shown on the attached list. These stations are equipped to perform warranty service on your BB gun, within the 90 day warranty period. Powerlets and Super BB's in convenient pocket size packs can be obtained from sporting goods dealers.

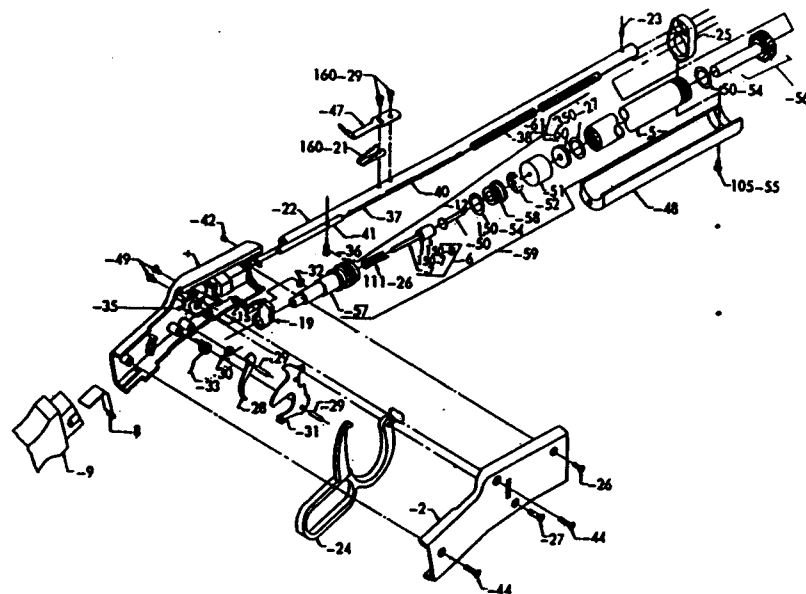

LIST OF PARTS AND ASSEMBLIES • MODEL 166

Part No.	Part Name	Price	Part No.	Part Name	Price
105-55	Rear Frame Screw		166-32	"O" Ring	
111-26	Check Valve Spring		166-33	Hammer Spring	
130-54	"O" Ring		166-35	Breech Block	
160-21	Rear Sight Elevator		166-36	Pusher Pin	
160-29	Rear Sight Screw		166-37	Ball Pusher Ext.	
166-1	Receiver, L. H.		166-38	Magazine Tube	
166-2	Receiver, R. H.		166-40	Magazine Spring	
166-5	Tube		166-41	Ball Pusher	
166-6	Valve Stem Assy.		166-42	Barrel Set Screw	
166-8	Lever Retainer		166-44	Receiver Screw	
166-9	Stock		166-47	Rear Sight	
166-12	Magazine Assy.		166-48	Forearm	
166-15	Feed Arm Spring		166-49	Breech Block Screw	
166-19	Feed Arm Assy.		166-50	Piercing Pin	
166-22	Barrel		166-51	Filter	
166-23	Front Sight		166-52	Screen	
166-24	Finger Lever		166-56	Tube Cap Assy.	
166-25	Strap		166-57	Valve Body	
166-26	Receiver Screw		166-58	Valve Bushing	
166-27	Lever Screw		166-59	Valve Assy.	
166-28	Trigger		166-60	Stop	
166-29	Trigger Pin - Hammer Pin		166-61	Stop Assy.	
166-30	Trigger Spring		350-27	"O" Ring	
166-31	Hammer				

Prices subject to change without notice. Check or money order in amount of total purchase must accompany parts order. Shipment will be prepaid.

Crosman 166



SPECIFICATIONS

Mechanism: Finger tip short stroke lever action
Caliber: Crosman Super BB
Weight: 3 lbs. 8 oz.
O.A. slant line length: 34 inches
Sight: Fixed front, fully adjustable rear sight
Barrel: 17 inch blued steel
Power: 1 Crosman Giant CO₂ Powerlet
Capacity: 30 Crosman Super BB single shot

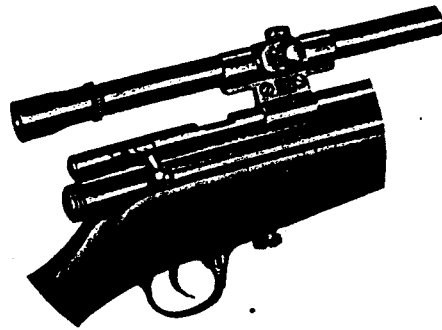

MASTER MOUNT and SUPERSCOPE

Model 410 fits this gun and all other Crosman Rifles
Model 499 fits 99 Rifle
4 power—nitrogen filled, adjustable reticles, focusing eye-piece. Requires only a screwdriver to mount.